

Vertical Slider Installation Manual

- 1 Remove the packing
Take out the parts as pictures
(See Picture1 and Picture2)

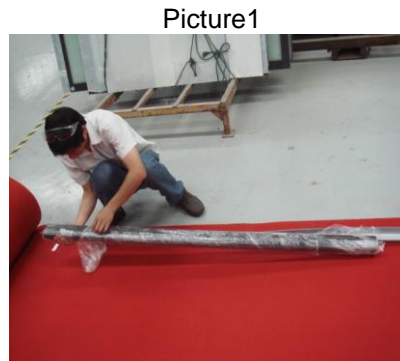

- 2 Tools
 - 1) Tool
 - a Electrical Screw Driver
 - b Rubber Hammer
- (See Picture3)
- c Silicon in Tube (according to different case)

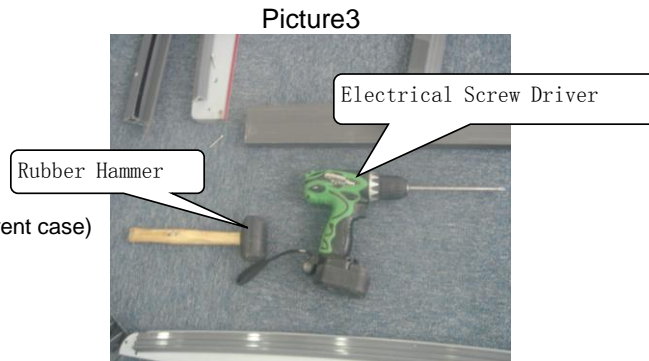

- 3 Put parts as Picture4 shows
This picture is structure completed
Main Parts and Names as shown

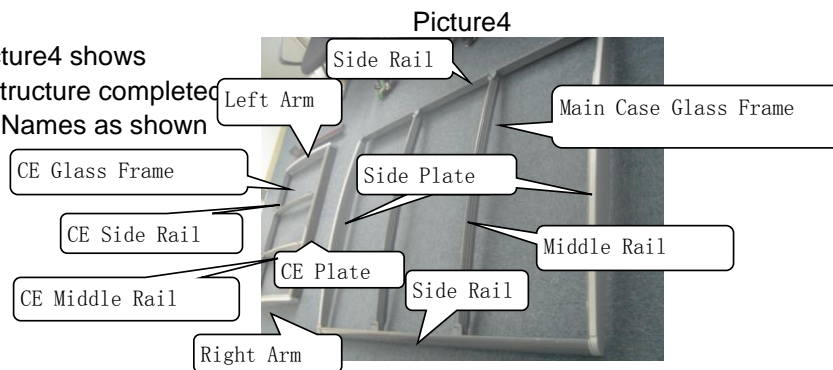

Main Case Glass Frame Installation

4 Install Joints on Side Rail

1) Parts

- a Side Rail (See Picture5)
- b Joint (See Picture6)

2) Step to install

- a Insert the Joint into Side Rail
Holes on Side Rail $\phi 12$ (See Picture7)
- b Use ST4.2*35 Screw to the Joint
Fix the Joint onto Side Rail
(See Picture8)

Note:

- # Use Electrical Screw Driver,
Do not over drive at the last
- # Do not forget to use ST4.2*35 Screw

Picture5

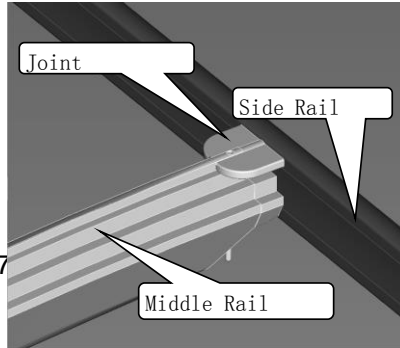

Picture6



Picture7

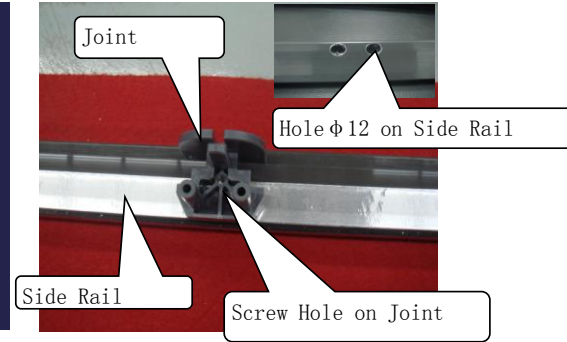

Picture8

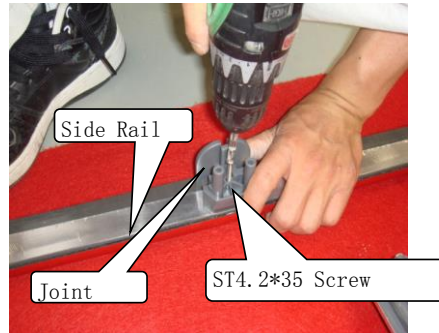

5 Install Middle Rail

1) Parts

- a Middle Rail (See Picture9)
- b Lock Pin (See Picture10)
- c Side Rail (See Picture11)

Picture9

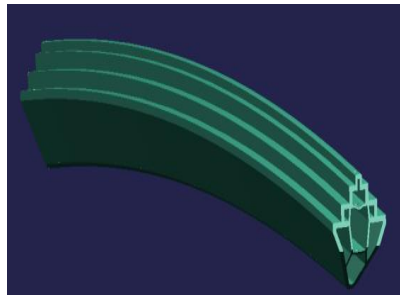

Picture10

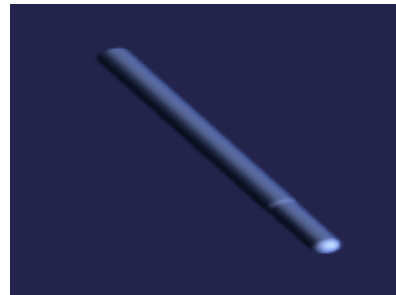

Picture11



2) Step to Install

- a Connect the Middle Rail to Joints (See Picture12)
- b Use Rubber Hammer to connect them (Please Hammer properly) (See Picture13)
- c Strike the Lock Pin into Joint Lock the Middle Rail(See Picture14) (Note the Lock Pin Small Head Down)

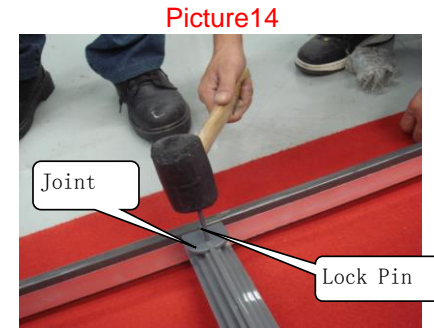
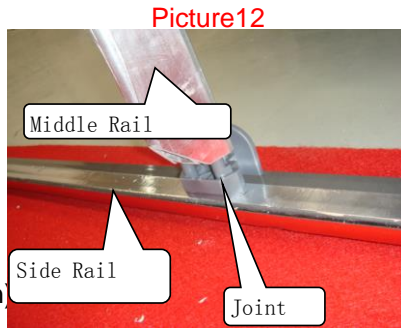

6 install Side Rail Cap

- 1) Parts
 - a Side Rail (See Picture16)
 - b Side Rail Cap-A (See Picture17)
- 2) Step
 - a Put the Cap into the end of Side Rail (See Picture18)

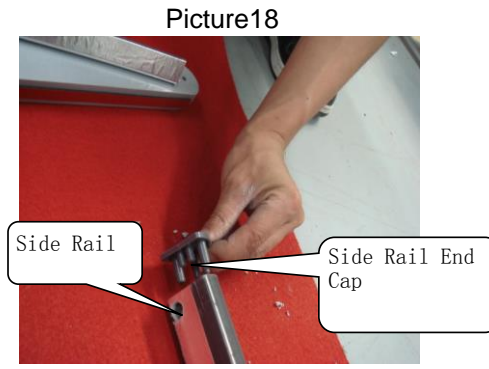
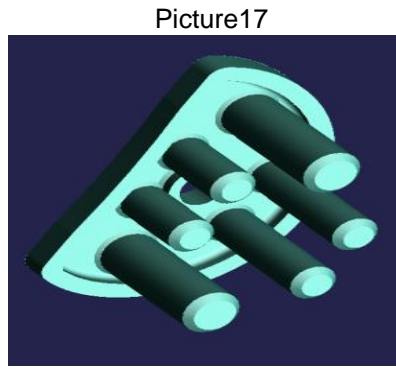
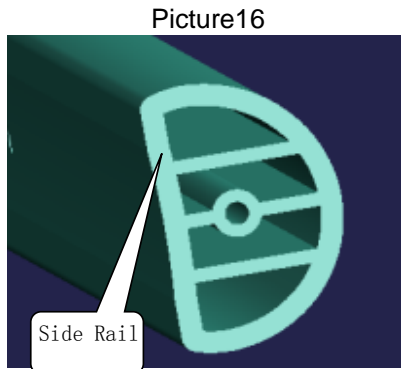

7 Fix the Middle Plate

- 1) Parts
 - a Middle Plate(See Picture19)
 - b Side Rail with End Cap Installed (See Picture20)
- 2) Step
 - a Fix the Middle Plate and Side Rail with ST4.8*50 Screw and $\phi 5$ Flat Washer(See Picture21)

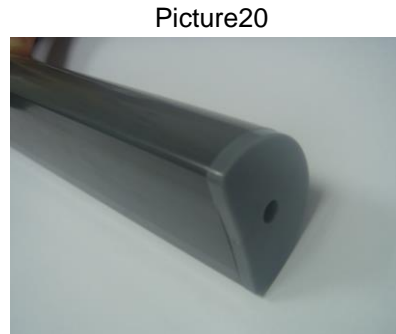
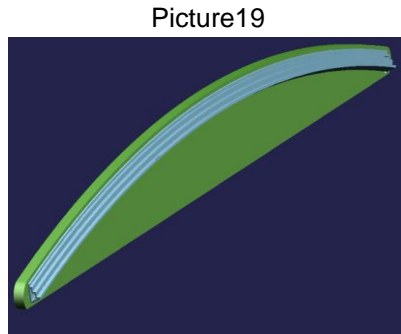

Picture22

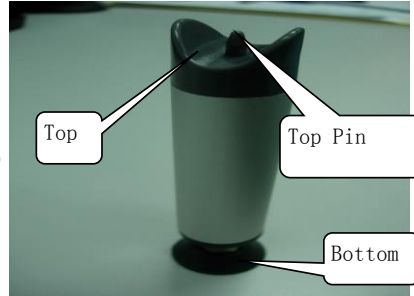

Picture23

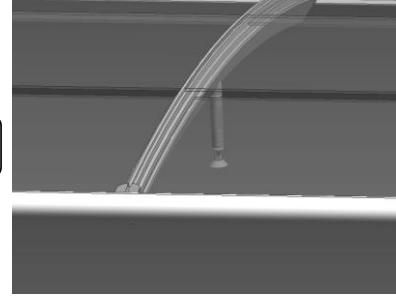

Picture24

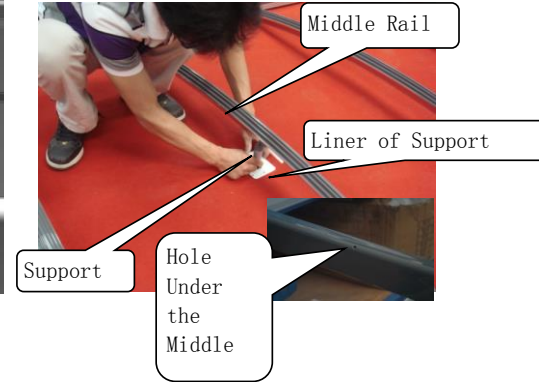

8 Install Middle Rail Support

- 1) Parts
 - a Support(See Picture22)
 - b Middle Rail(See Picture9)
 - c Liner(See Picture24 Under the Support)
- 2) Step
 - a Put the support on Middle of Middle Rail(See Picture23)
 - b Insert the Top Pin into the Hole under the Middle Rail Adjust the Middle Rail to Balance(See Picture24)
 - c Put the Liner under the Support

9 Main Case Glass Frame Assembly

- 1) Parts
 - a Main Case Frame (25-B)
 - b Rail Cap-B (25-C)
- 2) Step
 - a The Frame needs to lift by 3 or 4 people Then put the frame on showcase, do not twist the frame Twist the frame may cause damage
 - b Connect the Cap-B to the Side Rails (See Picture25-A) when two Side Rails meet together, there needs a Cap-B
 - c Install Joint (Refer to the Step4) Install the Middle Rail (Refer to the Step5 above)

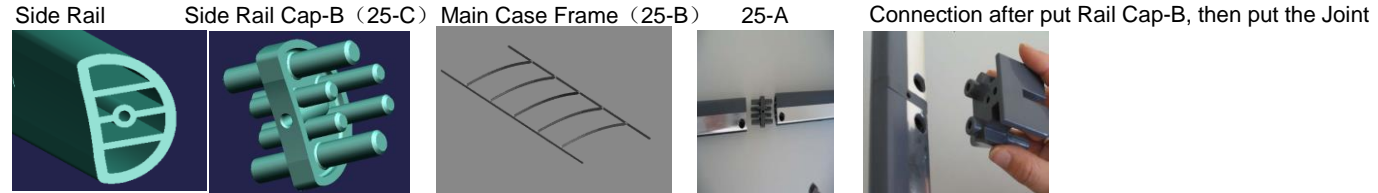

Note:
 Multiple Frame Connection will be better to them on the showcase

CE Glass Frame Installation

- 10 Put the unpacked parts as Picture4 All parts in position

CE Glass Frame putting(Picture25)

Picture25



Picture26



Picture27

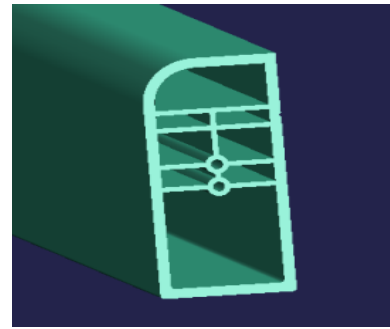

Picture28

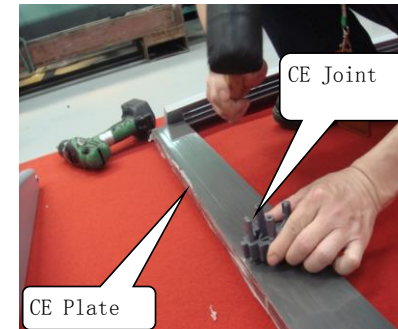

11 Install CE Joint to CE Plate

- 1) Parts
 - a CE Joint(See Picture26)
 - b CE Plate(See Picture27)
- 2) Steps
 - a Put the CE Joint into the CE Plate
In the $\phi 12$ Hole(See Picture28)
 - b Fix the CE Joint with ST4.2*35 Screw
Fix to the CE Plate(See Picture29)

Picture29



12 Install Joint to Side Rail of CE

- 1) Parts
 - a Side Rail of CE is just length different
with the Main Case Side Rail(Picture5)
 - b Joint(See Picture6)
(Same as Joint on Main Case Side Rail)
- 2) Steps
 - a Put the Joint into Side Rail
In the $\phi 12$ Hole (See Picture7)
 - b Use ST4.2*35 Screw fix the Joint
That already insert on the CE Side Rail
(See Picture8) Same as on the Main Case Side Rail

Note:

- # Use Electrical Screw Driver,
Do not over drive at the last
- # Do not forget to use ST4.2*35 Screw

13 Install CE Middle Rail

1) Parts

- a Middle Rail (See Picture9)
- b Lock Pin (See Picture10)
- c Side Rail (See Picture11 or Picture16)
- d CE Plate(See Picture27)

2) Step(Similar with the Main Case Middle Rail)

a Connect the Middle Rail

- to the Joint on Side Rail(Picture30)
- Connect the other end of Middle Rail to the CE Joint on CE Plate(Picture31)

b Use Rubber Hammer tap the Middle Rail to position (Please Hammer properly) (See Picture32)

c Tap the Lock Pin into Joint and Middle Rail Lock the Middle Rail(See Picture14) (Note the Lock Pin Small Head Down)

Picture30



Picture31

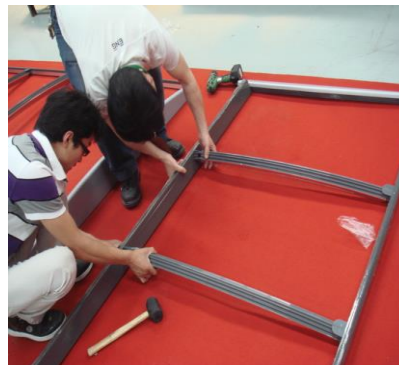

Picture32



Picture33

14 Install Side Rail Cap

1) Parts

- a Side Rail (See Picture11 or Picture16)
- b Side Rail Cap (See Picture17)

2) Steps

- a Put the Side Rail Cap into the Side Rail

Line up the screw hole (See Picture33)



Picture34

15 Connect CE Plate with Left and Right Arms

1) Parts

- a Left and Right Arm (See Picture34)
- b CE Plate(See Picture27)

2) Steps

- a Screw the Left and Right Arm with ST4.2*45 Screw and φ5 Flat Washer (See Picture35-36)

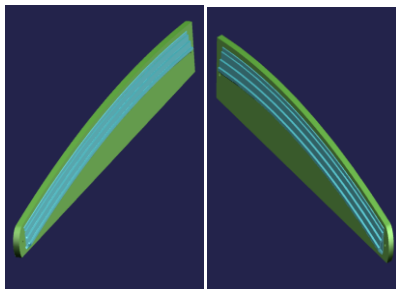

Picture35

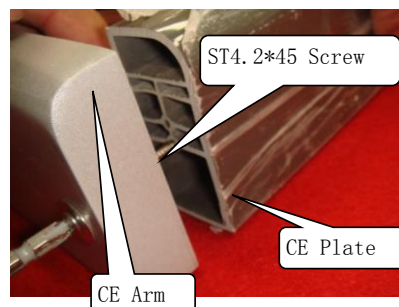

Picture36



Picture37



Picture38



16 Connect Side Rail and Left Right Arms

- 1) Parts
 - a Left Right Arms(See Picture34)
 - b Side Rail(with Joints)(See Picture20)
- 2) Steps
 - a Screw Left and Right Arm with ST4.8*50 Screw and φ5 Flat Washer (See Picture37-38)

Picture39



Picture40



17 Check the Assembled Maincase Frame and CE

- 1) Parts
 - a Completed CE Frame(See Picture39)
 - b Completed Main Case Frame(See Picture40)

18 Put Main Case Glasses

- 1) Parts
 - a Middle Glass (width bigger than left glass 15mm)
 - b Left Glass (width bigger than right glass 15mm)
 - c Right Glass (width smaller than left glass 15mm)

Middle Glass (fixed)

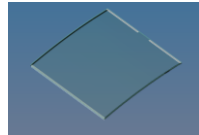

Left Glass

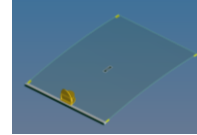

Right Glass

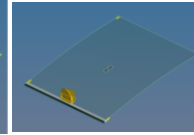

Picture41

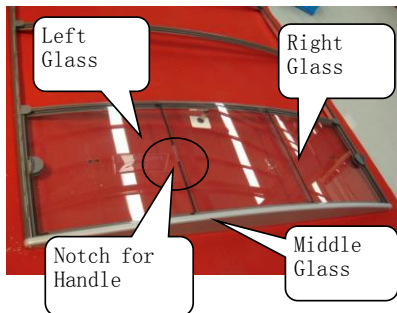

Picture42

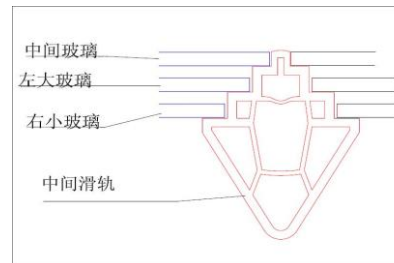

2) Steps

a Put Middle Glass

Middle Glass put in the Middle
Use Tape Meter position the glass
Remove the double sided tape
under glass, stick it on Rail
(See Picture43-44)

b Put Left Glass

Put the Left Glass on the Notch side

c Put Right Glass

Put the Right Glass at the other side
(See Picture41-42,45)

Note: Left Glass should be at the Notch Side

Picture43



Picture44

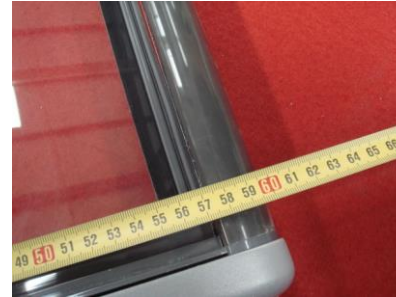

Picture45



19 Put the CE Glasses

1) Parts

- a Top Glass (width bigger than Middle glass 15mm)
- b Middle Glass (width bigger than Handle glass 15mm)
- c Handle Glass (width smaller than Middle glass 15mm)

Top Glass (Fixed)

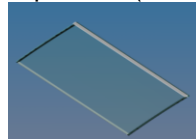

Middle Glass

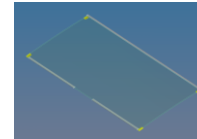

Handle Glass

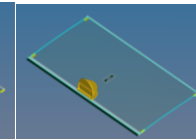

Picture46

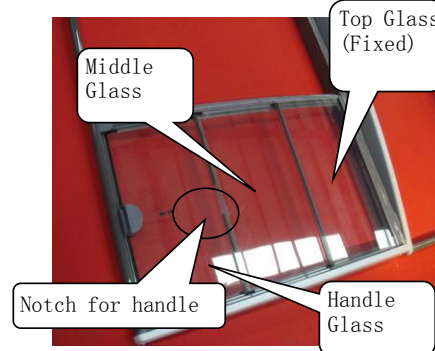

Picture47

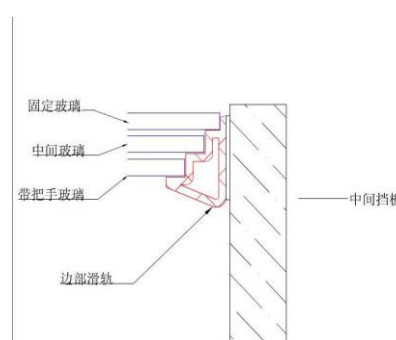

2) Steps

a Put the Top Glass (fixed)

b Put Middle Glass (Note the Notch towards Handle Glass)

c Put Handle Glass (See Picture46-47)

20 Check all parts and glasses fit OK
Remove the glasses, put the frame
on case, remove all double sided tapes
Stick the whole structure to the showcase
(See Picture48)

Double Sided Tape (Adjust some Height difference)
Because of the showcase difference
there may have 2mm gap between case
and structure,use double sided tape
to get the showcase all flat 4 sides.

Seal the gap with Silicon when necessary

图48

